



***Trunking & Accessories Guide,
Product Codes and
Fitting Instructions***



1/2-Round 16 x 8mm Micro Trunking

		White	Magnolia	Aluminium Effect	Black	Oak Effect
Lengths	3.0m Length	R3D1608W	-	-	-	-
	2.0m Length	R2D1608W	R2D1608M	R2D1608A	R2D1608B	R2D1608O
Accessories	Smooth-Fit Internal Bend	IB1608W	IB1608M	IB1608A	IB1608B	IB1608O
	Smooth-Fit External Bend	EB1608W	EB1608M	EB1608A	EB1608B	EB1608O
	Smooth-Fit Flat Bend	FB1608W	FB1608M	FB1608A	FB1608B	FB1608O
	Smooth-Fit Equal Tee	NET1608W	NET1608M	NET1608A	NET1608B	NET1608O
	Smooth-Fit Coupler	NCP1608W	NCP1608M	NCP1608A	NCP1608B	NCP1608O
	Smooth-Fit End Cap	EC1608W	EC1608M	EC1608A	EC1608B	EC1608O



1/2-Round 20 x 10mm Micro+ Trunking

		White
Lengths	3.0m Length	R3D2010W
	2.0m Length	R2D2010W
Clip-Over Accessories	Clip-Over Internal Bend	FLIB2010W
	Clip-Over External Bend	FLEB2010W
	Clip-Over Flat Bend	FLFB2010W
	Clip-Over Equal Tee	FLET2010W
Smooth-Fit Accessories	Smooth-Fit Coupler	CP2010W
	Smooth-Fit End Cap	EC2010W



1/2-Round 40 x 20mm Mini+ Trunking

		White
Lengths	3.0m Length	R3D4020W
	2.0m Length	R2D4020W
Accessories	Smooth-Fit Internal Bend	IB4020W
	Smooth-Fit External Bend	EB4020W
	Smooth-Fit Flat Bend	FB4020W
	Smooth-Fit Equal Tee	ET4020W
	Smooth-Fit Coupler	CP4020W
	Smooth-Fit End Cap	EC4020W
	Smooth-Fit Box Adaptor Tee	AT4020W



1/2-Round 30 x 15mm Mini Trunking

		White	Magnolia	Aluminium Effect	Black	Oak Effect	Red
Lengths	3.0m Length	R3D3015W	R3D3015M	R3D3015A	R3D3015B	R3D3015O	R3D3015R
	2.0m Length	R2D3015W	R2D3015M	R2D3015A	R2D3015B	R2D3015O	-
	3.0m Self Adhesive Internal Divider	3AD3015L	-	-	-	-	-
Clip-Over Accessories	Clip-Over Internal Bend	FLIB3015W	FLIB3015M	FLIB3015A	FLIB3015B	FLIB3015O	FLIB3015R
	Clip-Over External Bend	FLEB3015W	FLEB3015M	FLEB3015A	FLEB3015B	FLEB3015O	FLEB3015R
	Clip-Over Flat Bend	FLFB3015W	FLFB3015M	FLFB3015A	FLFB3015B	FLFB3015O	FLFB3015R
	Clip-Over Door Top Bend	FLDB3015W	FLDB3015M	FLDB3015A	FLDB3015B	FLDB3015O	FLDB3015R
	Clip-Over Equal Tee	FLET3015W	FLET3015M	FLET3015A	FLET3015B	FLET3015O	FLET3015R
	Clip-Over Flat Adaptor	FA3015W	-	-	-	-	FA3015R
Smooth-Fit Accessories	Smooth-Fit Internal Bend	IB3015W	IB3015M	IB3015A	IB3015B	IB3015O	IB3015R
	Smooth-Fit External Bend	EB3015W	EB3015M	EB3015A	EB3015B	EB3015O	EB3015R
	Smooth-Fit Flat Bend	FB3015W	FB3015M	FB3015A	FB3015B	FB3015O	FB3015R
	Smooth-Fit Equal Tee	ET3015W	ET3015M	ET3015A	ET3015B	ET3015O	ET3015R
	Smooth-Fit Cable Outlet	CO3015W	CO3015M	CO3015A	CO3015B	CO3015O	-
	Smooth-Fit Coupler	CP3015W	CP3015M	CP3015A	CP3015B	CP3015O	CP3015R
	Smooth-Fit End Cap	EC3015W	EC3015M	EC3015A	EC3015B	EC3015O	EC3015R
	Smooth-Fit Pattress Adaptor	PA3015W	-	-	-	-	-
	Smooth-Fit Circular Adaptor	CA3015W	-	-	-	-	CA3015R
	Smooth-Fit Box Adaptor	BA3015W	BA3015M	BA3015A	BA3015B	BA3015O	BA3015R
	Smooth-Fit Box Adaptor Tee	AT3015W	AT3015M	AT3015A	AT3015B	AT3015O	-



1/2-Round 50 x 25mm TV Trunking

		White	Magnolia	Aluminium Effect	Black	Oak Effect
Lengths	3.0m Length	R3D5025W	-	-	-	-
	2.0m Length	R2D5025W	R2D5025M	R2D5025A	R2D5025B	R2D5025O
	3.0m Self Adhesive Internal Divider	3AD5025L	-	-	-	-
Clip-Over Accessories	Clip-Over Internal Bend	FLIB5025W	FLIB5025M	FLIB5025A	FLIB5025B	FLIB5025O
	Clip-Over External Bend	FLEB5025W	FLEB5025M	FLEB5025A	FLEB5025B	FLEB5025O
	Clip-Over Flat Bend	FLFB5025W	FLFB5025M	FLFB5025A	FLFB5025B	FLFB5025O
	Clip-Over Equal Tee	FLET5025W	FLET5025M	FLET5025A	FLET5025B	FLET5025O
	Clip-Over Box Adaptor Tee	FLAT5025W	FLAT5025M	FLAT5025A	FLAT5025B	FLAT5025O
Smooth-Fit Accessories	Smooth-Fit Internal Bend	IB5025W	IB5025M	IB5025A	IB5025B	IB5025O
	Smooth-Fit External Bend	EB5025W	EB5025M	EB5025A	EB5025B	EB5025O
	Smooth-Fit Flat Bend	FB5025W	FB5025M	FB5025A	FB5025B	FB5025O
	Smooth-Fit Equal Tee	ET5025W	ET5025M	ET5025A	ET5025B	ET5025O
	Smooth-Fit Coupler	CP5025W	CP5025M	CP5025A	CP5025B	CP5025O
	Smooth-Fit End Cap	EC5025W	EC5025M	EC5025A	EC5025B	EC5025O
	Smooth-Fit Reducing Tee (to 30x15mm)	RT5030W	RT5030M	RT5030A	RT5030B	RT5030O
	Smooth-Fit Box Adaptor Tee	AT5025W	AT5025M	AT5025A	AT5025B	AT5025O
10mm Pipe Accessories	Twin 10mm Pipe-Clip Bend	DPP10	-	-	-	-
	Single 10mm Pipe-Clip Bend	SPB10	-	-	-	-
	10mm Pipe Exit End Cap	ECS5025W	-	-	-	-
	10mm Twin Pipe Clip	10PR52	-	-	-	-



1/2-Round 60 x 30mm Trunking

		White	Magnolia	Aluminium Effect	Black
Lengths	3.0m Length	R3D6030W	-	-	-
	2.0m Length	R2D6030W	R2D6030M	R2D6030A	R2D6030B
	3.0m Self Adhesive Internal Divider	3AD6030L	-	-	-
Smooth Fit Accessories	Smooth-Fit Internal Bend	IB6030W	IB6030M	IB6030A	IB6030B
	Smooth-Fit External Bend	EB6030W	EB6030M	EB6030A	EB6030B
	Smooth-Fit Flat Bend	FB6030W	FB6030M	FB6030A	FB6030B
	Smooth-Fit Equal Tee	ET6030W	ET6030M	ET6030A	ET6030B
	Smooth-Fit Cable Outlet	CO6030W	CO6030M	CO6030A	CO6030B
	Smooth-Fit Coupler	CP6030W	CP6030M	CP6030A	CP6030B
	Smooth-Fit End Cap	EC6030W	EC6030M	EC6030A	EC6030B
	15mm Twin Pipe Clip	15PR63W	-	-	-



1/4-Round 22 x 22mm Trunking/Floor Trim

		White	Oak Effect	Stainable	Light Oak Effect
Lengths	3.0m Length	R3D22QSW	-	-	-
	2.0m Length	R2D22QSW	R2D22QSO	R2D22QSP	RD222QSF1
Clip-Over Accessories	Clip-Over Internal / Flat Bend	FLIB22QSW	FLIB22QSO	FLIB22QSP	FLIB22QSF1
	Clip-Over External Bend	FLEB22QSW	FLEB22QSO	FLEB22QSP	FLEB22QSF1
	Clip-Over Inlet/Outlet	FLC022QSW	FLC022QSO	FLC022QSP	FLC022QSF1
Smooth-Fit Accessories	Smooth-Fit Internal/Flat Bend	FB22QSW	FB22QSO	FB22QSP	-
	Smooth-Fit External Bend	EB22QSW	EB22QSO	EB22QSP	-
	Smooth-Fit Cable Inlet	CI22QSW	CI22QSO	CI22QSP	-
	Smooth-Fit Cable Outlet	CO22QSW	CO22QSO	CO22QSP	-
	Smooth-Fit Coupler	CP22QSW	CP22QSO	CP22QSP	-
	Smooth-Fit End Cap (left)	EC22QSW/L	EC22QSO/L	EC22QSP/L	EC22QSF1/L
	Smooth-Fit End Cap (right)	EC22QSW/R	EC22QSO/R	EC22QSP/R	EC22QSF1/R



1/4-Round 30 x 30mm Trunking

		White	Magnolia	Oak Effect
Lengths	3.0m Length	R3D30QSW	-	-
	2.0m Length	R2D30QSW	R2D30QSM	R2D30QSO
Smooth-Fit Accessories	Smooth-Fit Internal / Flat Bend	FB30QSW	FB30QSM	FB30QSO
	Smooth-Fit External Bend	EB30QSW	EB30QSM	EB30QSO
	Smooth-Fit Cable Outlet	CO30QSW	CO30QSM	CO30QSO
	Smooth-Fit Corner Tee	CT30QSW	-	-
	Smooth-Fit Coupler	CP30QSW	CP30QSM	CP30QSO
	Smooth-Fit Box Adaptor	AT30QSW	-	AT30QSO
	Smooth-Fit Reducing Tee (to 30x15)	RT30QSW	RT30QSM	RT30QSO
	Smooth-Fit End Cap (left)	EC30QSW/L	EC30QSM/L	EC30QSO/L
	Smooth-Fit End Cap (right)	EC30QSW/R	EC30QSM/R	EC30QSO/R

Colours

W White
 M Magnolia
 A Aluminium Effect
 B Black
 O Oak Effect
 R Red
 P Premium Wood (stainable 22x22 only)*
 F1 Light Oak Effect

illustrations not to scale

Shape & size (wxh)

Trunking Lengths

3m Length
 2m Length
 3m Self Adhesive Divider
 suitable for all colours

								
	60x30mm	50x25mm	40x20mm	30x15mm	20x10mm	16x8mm	22x22mm	30x30mm
3m Length	<input type="checkbox"/>	<input type="checkbox"/>	<input type="checkbox"/>	<input type="checkbox"/>	<input type="checkbox"/>	<input type="checkbox"/>	<input type="checkbox"/>	<input type="checkbox"/>
2m Length	<input type="checkbox"/>	<input type="checkbox"/>	<input type="checkbox"/>	<input type="checkbox"/>	<input type="checkbox"/>	<input type="checkbox"/>	<input type="checkbox"/>	<input type="checkbox"/>
3m Self Adhesive Divider	<input type="checkbox"/>	<input type="checkbox"/>	<input type="checkbox"/>	<input type="checkbox"/>	<input type="checkbox"/>	<input type="checkbox"/>	<input type="checkbox"/>	<input type="checkbox"/>

Clip-Over Accessories

Flat Bend	<input type="checkbox"/>	<input type="checkbox"/>	<input type="checkbox"/>	<input type="checkbox"/>	<input type="checkbox"/>	<input type="checkbox"/>	<input type="checkbox"/>	<input type="checkbox"/>
Internal Bend	<input type="checkbox"/>	<input type="checkbox"/>	<input type="checkbox"/>	<input type="checkbox"/>	<input type="checkbox"/>	<input type="checkbox"/>	<input type="checkbox"/>	<input type="checkbox"/>
External Bend	<input type="checkbox"/>	<input type="checkbox"/>	<input type="checkbox"/>	<input type="checkbox"/>	<input type="checkbox"/>	<input type="checkbox"/>	<input type="checkbox"/>	<input type="checkbox"/>
Equal Tee	<input type="checkbox"/>	<input type="checkbox"/>	<input type="checkbox"/>	<input type="checkbox"/>	<input type="checkbox"/>	<input type="checkbox"/>	<input type="checkbox"/>	<input type="checkbox"/>
Door Top Bend	<input type="checkbox"/>	<input type="checkbox"/>	<input type="checkbox"/>	<input type="checkbox"/>	<input type="checkbox"/>	<input type="checkbox"/>	<input type="checkbox"/>	<input type="checkbox"/>
Box Adaptor Tee (50x25 only)	<input type="checkbox"/>	<input type="checkbox"/>	<input type="checkbox"/>	<input type="checkbox"/>	<input type="checkbox"/>	<input type="checkbox"/>	<input type="checkbox"/>	<input type="checkbox"/>
Inlet/Outlet Coupler (22x22 only)	<input type="checkbox"/>	<input type="checkbox"/>	<input type="checkbox"/>	<input type="checkbox"/>	<input type="checkbox"/>	<input type="checkbox"/>	<input type="checkbox"/>	<input type="checkbox"/>
Flat Adaptor	<input type="checkbox"/>	<input type="checkbox"/>	<input type="checkbox"/>	<input type="checkbox"/>	<input type="checkbox"/>	<input type="checkbox"/>	<input type="checkbox"/>	<input type="checkbox"/>

Smooth Fit Accessories

Flat Bend	<input type="checkbox"/>	<input type="checkbox"/>	<input type="checkbox"/>	<input type="checkbox"/>	<input type="checkbox"/>	<input type="checkbox"/>	<input type="checkbox"/>	<input type="checkbox"/>
Internal Bend	<input type="checkbox"/>	<input type="checkbox"/>	<input type="checkbox"/>	<input type="checkbox"/>	<input type="checkbox"/>	<input type="checkbox"/>	<input type="checkbox"/>	<input type="checkbox"/>
External Bend	<input type="checkbox"/>	<input type="checkbox"/>	<input type="checkbox"/>	<input type="checkbox"/>	<input type="checkbox"/>	<input type="checkbox"/>	<input type="checkbox"/>	<input type="checkbox"/>
Equal Tee	<input type="checkbox"/>	<input type="checkbox"/>	<input type="checkbox"/>	<input type="checkbox"/>	<input type="checkbox"/>	<input type="checkbox"/>	<input type="checkbox"/>	<input type="checkbox"/>
Cable Outlet	<input type="checkbox"/>	<input type="checkbox"/>	<input type="checkbox"/>	<input type="checkbox"/>	<input type="checkbox"/>	<input type="checkbox"/>	<input type="checkbox"/>	<input type="checkbox"/>
Cable Inlet	<input type="checkbox"/>	<input type="checkbox"/>	<input type="checkbox"/>	<input type="checkbox"/>	<input type="checkbox"/>	<input type="checkbox"/>	<input type="checkbox"/>	<input type="checkbox"/>
Reducing Tee (to 30x15mm)	<input type="checkbox"/>	<input type="checkbox"/>	<input type="checkbox"/>	<input type="checkbox"/>	<input type="checkbox"/>	<input type="checkbox"/>	<input type="checkbox"/>	<input type="checkbox"/>
Coupler	<input type="checkbox"/>	<input type="checkbox"/>	<input type="checkbox"/>	<input type="checkbox"/>	<input type="checkbox"/>	<input type="checkbox"/>	<input type="checkbox"/>	<input type="checkbox"/>
End Cap	<input type="checkbox"/>	<input type="checkbox"/>	<input type="checkbox"/>	<input type="checkbox"/>	<input type="checkbox"/>	<input type="checkbox"/>	<input type="checkbox"/>	<input type="checkbox"/>
End Cap Left (¼ round only)	<input type="checkbox"/>	<input type="checkbox"/>	<input type="checkbox"/>	<input type="checkbox"/>	<input type="checkbox"/>	<input type="checkbox"/>	<input type="checkbox"/>	<input type="checkbox"/>
End Cap Right (¼ round only)	<input type="checkbox"/>	<input type="checkbox"/>	<input type="checkbox"/>	<input type="checkbox"/>	<input type="checkbox"/>	<input type="checkbox"/>	<input type="checkbox"/>	<input type="checkbox"/>
10mm Pipe Exit End Cap	<input type="checkbox"/>	<input type="checkbox"/>	<input type="checkbox"/>	<input type="checkbox"/>	<input type="checkbox"/>	<input type="checkbox"/>	<input type="checkbox"/>	<input type="checkbox"/>
Corner Tee	<input type="checkbox"/>	<input type="checkbox"/>	<input type="checkbox"/>	<input type="checkbox"/>	<input type="checkbox"/>	<input type="checkbox"/>	<input type="checkbox"/>	<input type="checkbox"/>
Box Adaptor Tee	<input type="checkbox"/>	<input type="checkbox"/>	<input type="checkbox"/>	<input type="checkbox"/>	<input type="checkbox"/>	<input type="checkbox"/>	<input type="checkbox"/>	<input type="checkbox"/>
30x15mm Box Adaptor	<input type="checkbox"/>	<input type="checkbox"/>	<input type="checkbox"/>	<input type="checkbox"/>	<input type="checkbox"/>	<input type="checkbox"/>	<input type="checkbox"/>	<input type="checkbox"/>
Patress Adaptor	<input type="checkbox"/>	<input type="checkbox"/>	<input type="checkbox"/>	<input type="checkbox"/>	<input type="checkbox"/>	<input type="checkbox"/>	<input type="checkbox"/>	<input type="checkbox"/>
Circular Adaptor	<input type="checkbox"/>	<input type="checkbox"/>	<input type="checkbox"/>	<input type="checkbox"/>	<input type="checkbox"/>	<input type="checkbox"/>	<input type="checkbox"/>	<input type="checkbox"/>

Safe-D Clips - Fire Rated

SAFE-D30 (BS5839 part 1)	<input type="checkbox"/>	<input type="checkbox"/>	<input type="checkbox"/>	<input type="checkbox"/>	<input type="checkbox"/>	<input type="checkbox"/>	<input type="checkbox"/>	<input type="checkbox"/>
SAFE-D40 (BS5839 part 1)	<input type="checkbox"/>	<input type="checkbox"/>	<input type="checkbox"/>	<input type="checkbox"/>	<input type="checkbox"/>	<input type="checkbox"/>	<input type="checkbox"/>	<input type="checkbox"/>
SAFE-D50 (BS5839 part 1)	<input type="checkbox"/>	<input type="checkbox"/>	<input type="checkbox"/>	<input type="checkbox"/>	<input type="checkbox"/>	<input type="checkbox"/>	<input type="checkbox"/>	<input type="checkbox"/>

Surface Boxes

28mm Deep Single	<input type="checkbox"/>
28mm Deep Twin	<input type="checkbox"/>
35mm Deep Single	<input type="checkbox"/>
35mm Deep Twin	<input type="checkbox"/>
28mm Rounded Single	<input type="checkbox"/>
28mm Rounded Twin	<input type="checkbox"/>
35mm Rounded Single	<input type="checkbox"/>
35mm Rounded Twin	<input type="checkbox"/>



* All oak/wood trunking accessories are brown finish, but can be stained to achieve best colour co-ordination to stained lengths (key surface of accessory with fine abrasive prior to staining)

1/2-Round Clip-Over Accessories - For 20x10mm, 30x15mm and 50x25mm only

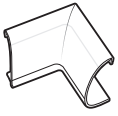

Internal Bend

Join lengths around 90 degree inside corners.



External Bend

Join lengths around 90 degree outside corners.

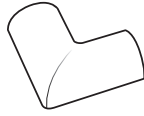

Flat Bend

Change direction by 90 degrees on flat surfaces.

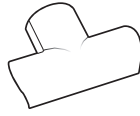

Equal Tee

Use to join 3 lengths of same profile.

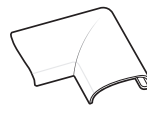

Door Top Bend

Change direction by 90 degrees around frame tops.

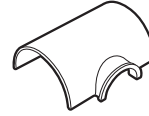

Box Adaptor Tee

For use with D-Line Surface Socket Boxes. **50 x 25mm only**

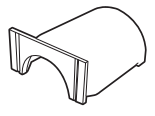

Flat Adaptor

Connect Mini Trunking to flat surfaces **30 x 15mm only**

1/4-Round Clip-Over Accessories - For 22x22mm only



Internal Bend

Join lengths around 90 degree inside corners.



External Bend

Join lengths around 90 degree outside corners.



Cable Inlet/Outlet

Use to provide cable entry/exit point between 2 lengths.



Use with Smooth-Fit Couplers & End Caps

1/2-Round Smooth-Fit Accessories

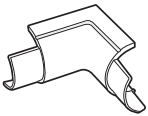

Internal Bend

Join lengths around 90 degree inside corners.

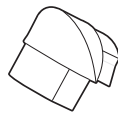

External Bend

Join lengths around 90 degree outside corners.

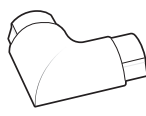

Flat Bend

Change direction by 90 degrees on flat surfaces.

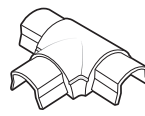

Equal Tee

Use to join 3 lengths of same profile.

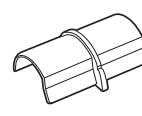

Coupler

Join 2 lengths of same profile on flat surface.

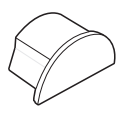

End Cap

Neatly finish open ends.

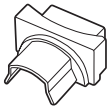

Pattress Adaptor

Connect Mini Trunking to round surface pattresses. **30 x 15mm only**

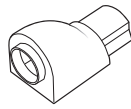

Circular Adaptor

Connect Mini Trunking to flat edge surfaces with 20mm Ø knock-outs. **30 x 15mm only**

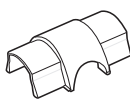

Cable Inlet/Outlet

Takes cables in or out of a Mini Trunking. Use between lengths on straight runs. **30 x 15mm only**

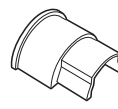

Box Adaptor

For use with D-Line Surface Socket Boxes. **30 x 15mm only**

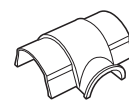

Box Adaptor Tee

For use with D-Line Surface Socket Boxes.

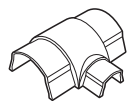

Reducing Tee

Connect to 30 x 15mm Mini Trunking.

1/4-Round Smooth-Fit Accessories



Internal Bend

Join lengths around 90 degree inside corners.

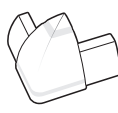

External Bend

Join lengths around 90 degree outside corners.

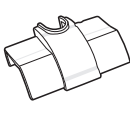

Cable Inlet

Use to provide cable entry point between 2 lengths.

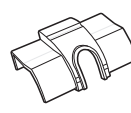

Cable Outlet

Use to provide cable exit point between 2 lengths.

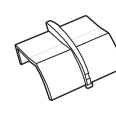

Coupler

Joins 2 lengths on flat surfaces.

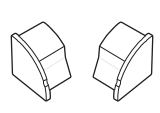

End Cap

Neatly finish open ends (left & right versions apply).

Other Accessories

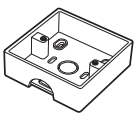

Single Surface Socket Box

For use with 30 x 15mm, 40 x 20mm & 50 x 25mm Trunking. Available in 28mm & 35mm depth.

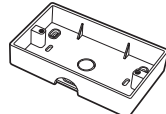

Twin Surface Socket Box

For use with 30 x 15mm, 40 x 20mm & 50 x 25mm Trunking. Available in 28mm & 35mm depth.



SAFE-D30 Clip

Fire rated cable clip for use with 30 x 15mm D-Line & 25mm+ wide traditional trunkings. Safe-D Red version also available.

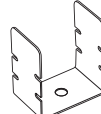

SAFE-D40 Clip

Fire rated cable clip for use with 40 x 20mm & 50 x 25mm D-Line & 40mm+ wide traditional trunkings.

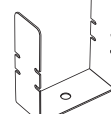

SAFE-D50 Clip

Fire rated cable clip for use with 60 x 30mm D-Line & 50mm+ wide traditional trunkings.



Ratchet Cutting Tool

Use to cut up to 40mm wide D-Line Trunking.



Fitting Guide for 1/2 round D-Line



Measuring up

Plan your cable path. Check that you have all parts required. Next consider the space that will be needed for any accessories needed.

Clip-Over accessories allow a tolerance for imprecise measurements and untidy cuts.

Smooth Fit accessories give a smooth flush-alignment for perfect finish, but require precise measurements and straight cuts.

For Smooth fit use the accessory part as a template; pencil mark the surface at the shoulder points of the accessory.

These pencil marks indicate the point that the D-Line length needs to measure up to.

Clip-Over example...

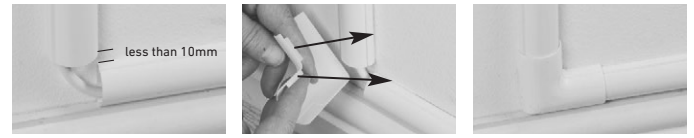

Smooth fit example...

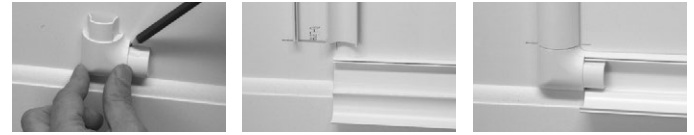

Cutting & Installing Lengths



- Measure length(s). Pencil mark where cut is required.
- Use a mitre block and junior hacksaw to cut at the outer edge of the pencil mark.
- Remove the protective film cover.
- To peel & stick... Make sure the surface is clean & dry. Alternatively lengths can be drilled and screw fixed; as recommended for profiles with bases wider than 35mm.
- For easier installation we recommend that horizontal runs are fixed with the click lock at the top and the hinge at the base.
- Take care when positioning lengths, as a strong bond will be created with the surface.

Installing cables & accessories

Clip-Over

Lay cables into lengths, close the lid ensuring it snaps shut, then clip the accessory in place. The tabs clip over the top of the lengths.

Internal Bend

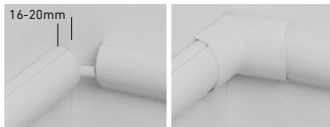

External Bend

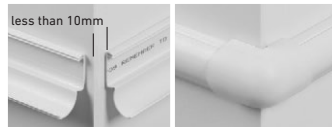

Flat Bend

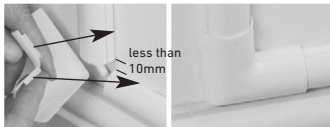

Equal Tee

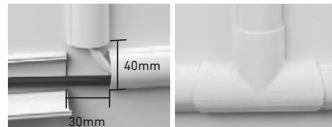

Door Top Bend

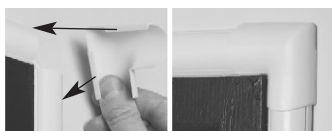

NOTE: some Clip-Over accessories have a section of self adhesive tape applied to the reverse. This helps secure the piece in place, please use if necessary.

After Care

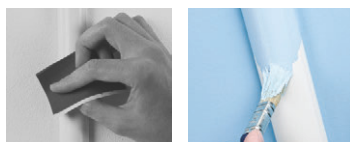

D-Line can accept gloss or emulsion paints... For best results use fine sandpaper to key the surface prior to painting.

Smooth Fit

Lay cables into lengths, place the required accessory over the cables, then close the lid ensuring it snaps shut.

The lengths hold the accessories in position.

Internal Bend

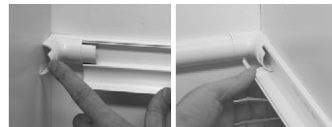

External Bend

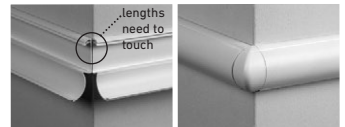

Flat Bend



Equal Tee



Cable Inlet/Outlet

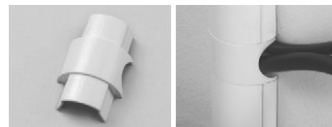

Connector

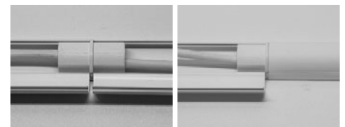

End Cap

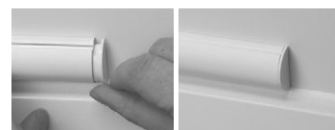

It may be necessary to shape some accessories to allow for imperfections on walls.

Important: If using D-Line for high voltage mains cables it is recommended you leave 45%+ of internal capacity for air circulation.



Fitting Guide for ¼ round D-Line

D-Line®

Measuring Up

Plan your cable path. Check that you have all parts required. Next consider the space that will be needed for any accessories needed.

Clip-Over accessories allow a tolerance for imprecise measurements and untidy cuts.

Smooth Fit accessories give a smooth flush-alignment for perfect finish, but require precise measurements and straight cuts.

For Smooth fit use the accessory part as a template; pencil mark the surface at the shoulder points of the accessory.

These pencil marks indicate the point that the D-Line length needs to measure up to.

Clip-Over example...



Smooth fit example...



Cutting & Installing Lengths



- Measure length(s). Pencil mark where cut is required.
- Use a mitre block and junior hacksaw to cut at the outer edge of the pencil mark.
- Remove the protective film cover.
- To peel & stick... Make sure the surface is clean & dry.
- Horizontal runs should be fixed with the click lock at the top and the hinge at the base as shown to the right.
- Take care when positioning lengths, as a strong bond will be created with the surface.



Installing cables & accessories

Clip-Over

Lay cables into lengths, close the lid ensuring it snaps shut, then clip the accessory in place. The tabs clip over the top of the lengths.

Internal Bend



External Bend

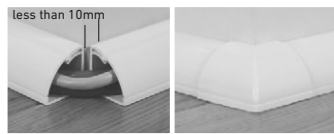

Connector / Cable Inlet

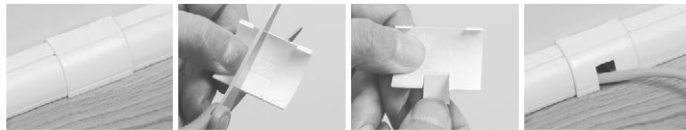

NOTE: some Clip-Over accessories have a section of self adhesive tape applied to the reverse. This helps secure the piece in place, please use if necessary.

After Care

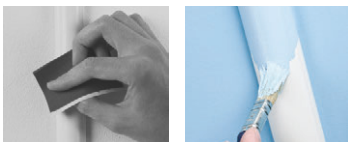

D-Line can accept gloss or emulsion paints... For best results use fine sandpaper to key the surface prior to painting.

Smooth Fit

Lay cables into lengths, place the required accessory over the cables, then close the lid ensuring it snaps shut.

The lengths hold the accessories in position.

Internal Bend



External Bend

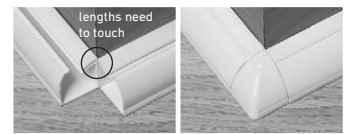

Cable Inlet/Outlet

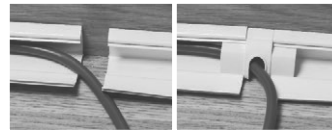

Connector

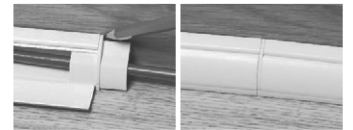

End Cap



Note: there are left and right sided end caps



It may be necessary to shape some accessories to allow for imperfections on walls.

Important: If using D-Line for high voltage mains cables it is recommended you leave 45%+ of internal capacity for air circulation.

D-LINE®

D-Line (Europe) Limited

Unit A5 Tromso Close, Tyne Tunnel Trading Estate, North Shields, Tyne & Wear NE29 7XH United Kingdom

Tel: +44 (0)191 236 0960 Sales: +44 (0)191 237 9156 Finance: +44 (0)191 237 9157 Customer Services: +44 (0)191 237 9158

Fax: +44 (0)191 236 0979 Email: enquiries@d-line-it.com Web: www.d-line-it.com